

Driver Card

To begin using the 24 HOS ELD, complete the following steps:

- Log in to the application with your username and password.
- Plug in the device to a suitable power source inside your vehicle.
- Place the device securely on your dashboard to ensure stable operation.

1. Malfunctions and data

inconsistencies icon shows if there are any issues with a track or ELD.

2. Truck icon shows track to PT30 connection.

3. Flag icon shows the rules of which country you are following at the moment.

4. Name icon shows the name of the driver whose working hours are counting at the moment.

5. Co-driver icon allows to switch a driver.

6. Notifications.

7. Track speed.

8. Available driving time.

9. Current status.

10. Status switch menu.

11. HOS counter.

12. HOS menu icon.

13. Log menu icon.

14. DOT inspection menu icon.

15. DVIR menu icon.

16. Additional Menu icon.

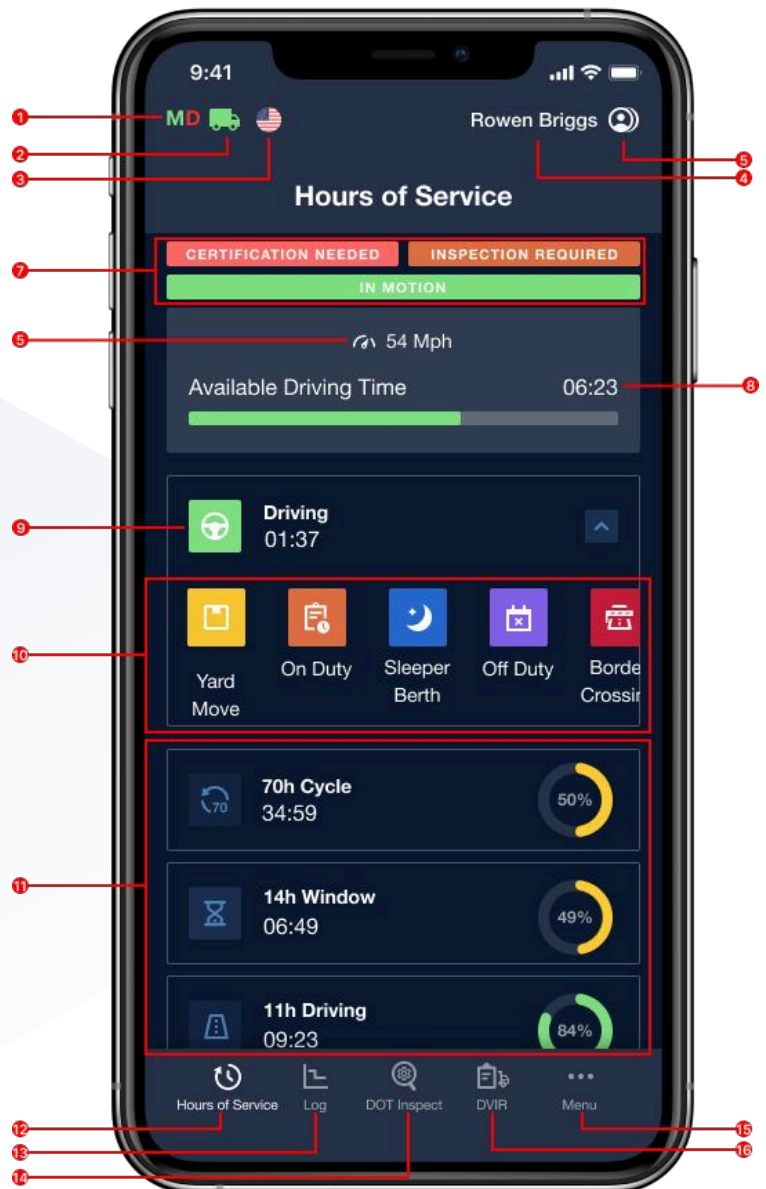

DOT Inspection

The DOT Inspection menu provides summaries of all the collected data regarding a driver, truck, and trip.

You may also use this menu to transfer the data to FMCSA during the DOT inspection, certify your logs, or view unidentified records.

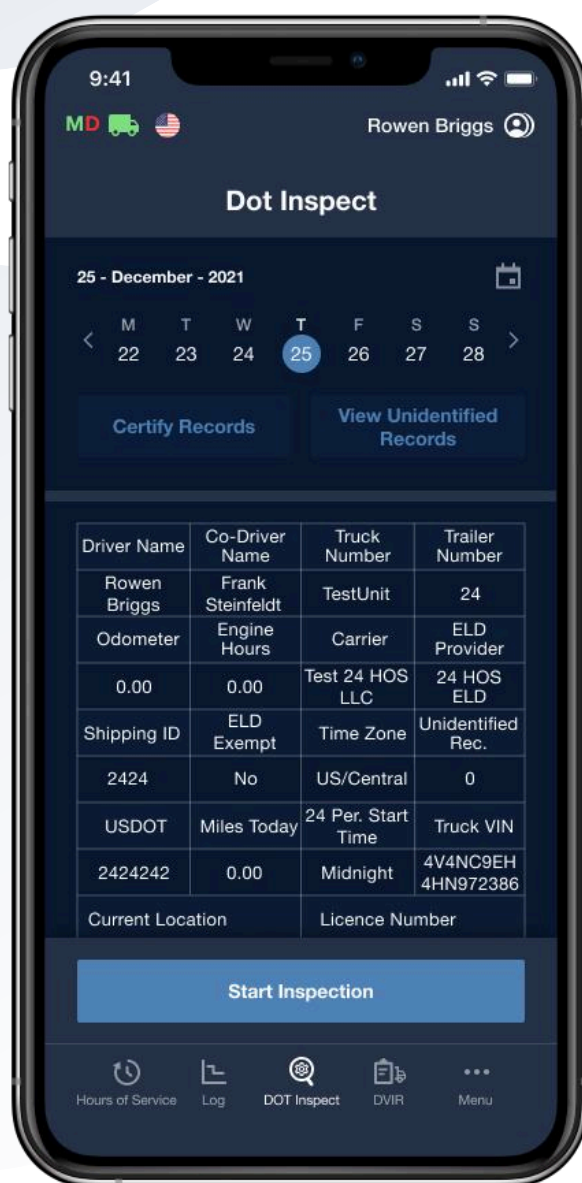

Tap the Start Inspection button and check if your logs are ready to be transferred to the safety officials.

Data Transfer

If everything is OK, tap the “Transfer Data to Police” button and choose the method of sending your logs:

- **Send it to the Web Services (FMCSA)**
- **Send it to the FMCSA email**

You need to add a comment and tap the “Send CSV” button to complete the Data Transfer.

The reporting period will vary depending on the rules of the country in which you operate.

Also you can choose “Send it to the personal email”. You need to enter the recipient’s address, add a comment (optional) and tap the “Send PDF” button.

